

ROUND TAPERED

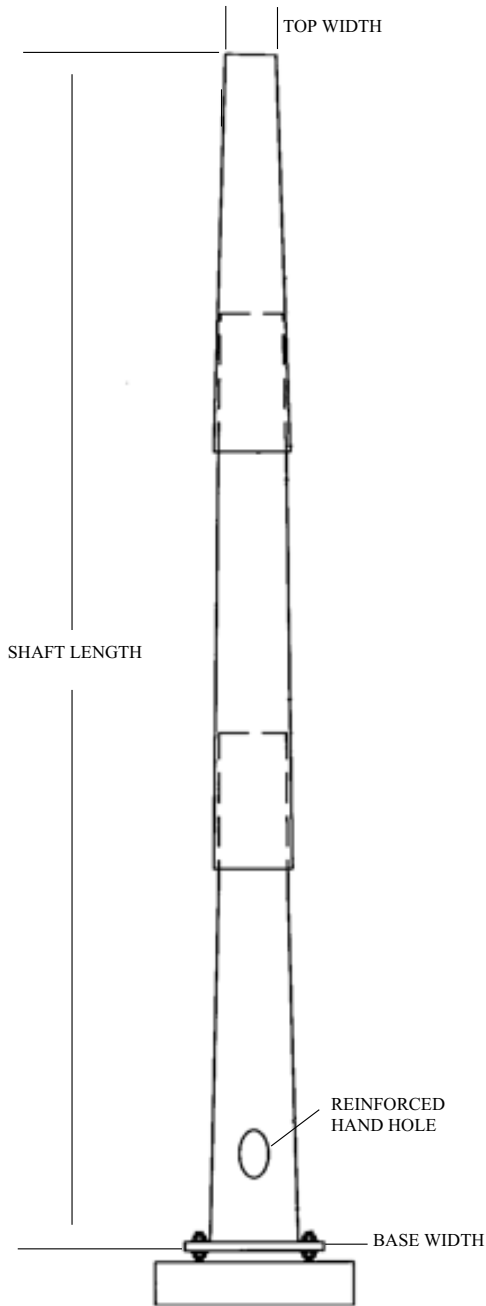

STEEL ARM

SEE STEEL ARM SECTION

ANCHOR BASE DATA

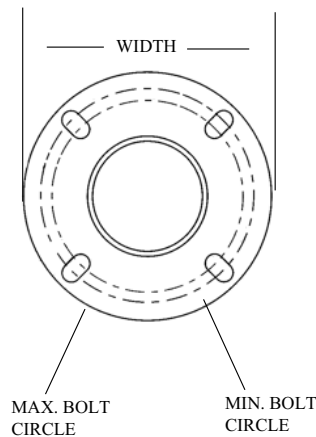

STRUCTURAL DESIGN

Steel poles are designed for the combined effects of both wind and dead load. The wind load effects have been analyzed with wind velocities ranging from 70 to 120 mph plus a 1.3 gust factor. Due to varying wind effects, height correction factors and drag coefficients have been applied to the entire structure. The dead load effects have been determined by using a final deflected position analysis to account for secondary moments caused by eccentric dead loads.

MATERIALS

All Steel pole shafts are made from a single ply steel sheet. This sheet is formed into a tubular shape with one or more longitudinal welds, no weld splices are permitted. This tubular shape has a cross section which is either round or square and is either tapered or non tapered along its length. Standard taper rates include 0.11 inches per foot for square poles and 0.14 inches per foot for round poles. Materials used for the pole shafts meets the requirements of ASTM A500 Grade-C, ASTM A595 Grade A, or ASTM A-572 GR. 65. Poles which exceed 50 feet in length, are designed as two-piece assemblies. These two-piece assemblies are joined together telescoping the upper female section over the lower male section by a minimum lap distance of 1.5 times the female inside diameter. The longitudinal weld seam on the female section is welded both inside and out to insure 100% weld penetration at the telescoped area. Pole assemblies, which exceed 50 feet in height, are also designed with an internal cable guide and strain relief mechanism, which is typically attached at the mid-height of the pole assembly.

BASE PLATE

The anchor base plate is integrally welded to the bottom pole section of all anchor base assemblies with either a telescopic weld or a full penetration weld with a back up bar. The material used for these plates will conform to either ASTM A36 or ASTM A572

FINISH

Each lighting standard is hot dip galvanized or painted. All paint is applied by either powder coat or wet spray process.

SPORTS LIGHTING -ANCHOR BASE

| Catalog Number | Gross Weight (lbs) | Pole Shaft Data | | | | | | Base Plate Data | | | | Anchor Bolt Data | | | |
|----------------|--------------------|-----------------------|-------------------------|-------------------------|-------------------------|-------------------------|----------------------|-----------------|------------|------------------|------------|------------------|-----------|-------------|-----------|
| | | Section | Base O.D. (in) | Top O.D. (in) | Wall Thick (in) | Shaft Length (ft) | Weight (lbs) | Shape | Width (in) | Bolt Circle (in) | Thick (in) | Qty. | Dia. (in) | Length (in) | Hook (in) |
| SLT-50-WL-AB | 489 | Base | 10.00 | 4.00 | .1196 | 50.00 | 435 | Round | 16 | 13.5 | 1 | 4 | 1.25 | 42 | 6.0 |
| SLT-50-WM-AB | 724 | Base | 10.00 | 4.00 | .1875 | 50.00 | 659 | Round | 17 | 14 | 1.25 | 4 | 1.5 | 54 | 6.0 |
| SLT-50-WH-AB | 848 | Base | 11.00 | 4.00 | .1875 | 50.00 | 764 | Round | 18 | 15 | 1.25 | 4 | 1.5 | 54 | 6.0 |
| SLT-50-WK-AB | 965 | Base | 12.00 | 5.00 | .1875 | 50.00 | 868 | Round | 20 | 16.5 | 1.5 | 4 | 1.75 | 54 | 6.0 |
| SLT-60-WL-AB | 733 | Base Top | 12.00 8.00 | 7.47 3.84 | .1196 .1196 | 32.36 29.72 | 424 235 | Round | 18 | 15.5 | 1 | 4 | 1.25 | 42 | 6.0 |
| SLT-60-WM-AB | 1108 | Base Top | 12.00 8.00 | 7.34 3.97 | .1875 | 33.32 28.75 | 660 348 | Round | 19 | 16 | 1.25 | 4 | 1.5 | 54 | 6.0 |
| SLT-60-WH-AB | 1254 | Base Top | 13.00 9.00 | 8.32 4.97 | .1875 | 33.44 28.75 | 732 408 | Round | 21 | 17.5 | 1.5 | 4 | 1.75 | 54 | 6.0 |
| SLT-60-WK-AB | 1552 | Base Top | 15.00 12.00 | 11.27 6.98 | .1875 | 26.67 35.89 | 731 697 | Round | 22 | 19 | 1.25 | 6 | 1.5 | 54 | 6.0 |
| SLT-70-WL-AB | 1327 | Base Top | 13.00 9.00 | 8.32 3.57 | .1875 | 33.44 38.75 | 732 494 | Round | 20 | 17 | 1.25 | 4 | 1.5 | 54 | 6.0 |
| SLT-70-WM-AB | 1685 | Base Top | 15.00 12.00 | 11.27 5.58 | .1875 | 26.67 45.89 | 731 825 | Round | 20 | 19 | 1.25 | 6 | 1.5 | 54 | 6.0 |
| SLT-70-WH-AB | 1989 | Base Top | 17.00 12.00 | 11.27 7.57 | .1875 | 40.96 31.61 | 1209 634 | Round | 24 | 21 | 1.25 | 8 | 1.5 | 54 | 6.0 |
| SLT-70-WK-AB | 2784 | Base Top | 21.50 17.00 | 16.18 12.07 | .1875 | 38.01 35.18 | 1501 1069 | Round | 30 | 26 | 1.25 | 10 | 1.5 | 54 | 6.0 |
| SLT-80-WP-AB | 1825 | Base Top | 16.50 10.00 | 9.43 5.54 | .1875 .1196 | 50.47 31.86 | 1365 332 | Round | 23.5 | 20.5 | 1.25 | 4 | 1.5 | 54 | 6.0 |
| SLT-80-WL-AB | 2136 | Base Top | 17.00 12.00 | 11.27 6.17 | .1875 | 40.96 41.61 | 1209 774 | Round | 24 | 21 | 1.25 | 6 | 1.5 | 54 | 6.0 |
| SLT-80-WM-AB | 2607 | Base Top | 19.50 13.00 | 12.25 8.67 | .1875 | 51.80 30.89 | 1720 687 | Round | 28 | 24 | 1.25 | 8 | 1.5 | 54 | 6.0 |
| SLT-80-WH-AB | 3029 | Base Top | 21.50 17.00 | 16.18 10.67 | .1875 | 38.01 45.18 | 1501 1305 | Round | 30 | 26 | 1.25 | 10 | 1.5 | 54 | 6.0 |
| SLT-80-WK-AB | 4043 | Base Top | 22.00 17.00 | 16.06 11.30 | .2500 | 42.43 40.71 | 2226 1581 | Round | 31 | 27 | 1.25 | 12 | 1.5 | 54 | 6.0 |
| SLT-90-WL-AB | 2250 | Base Top | 17.00 12.00 | 11.27 4.77 | .1875 | 40.96 51.61 | 1209 884 | Round | 24 | 21 | 1.25 | 6 | 1.5 | 54 | 6.0 |
| SLT-90-WM-AB | 2761 | Base Top | 19.50 13.00 | 12.25 7.27 | .1875 | 51.80 40.89 | 1720 850 | Round | 27 | 24 | 1.25 | 8 | 1.5 | 54 | 6.0 |
| SLT-90-WH-AB | 3385 | Base Middle Top | 21.50 17.00 12.00 | 16.18 11.27 9.65 | .1875 | 38.01 40.96 16.79 | 1501 1209 373 | Round | 31 | 27 | 1.25 | 6 | 1.75 | 54 | 6.0 |
| SLT-100-WL-AB | 2434 | Base Middle Top | 17.00 12.00 8.00 | 11.27 7.34 3.75 | .1875 | 40.96 33.32 30.36 | 1209 660 361 | Round | 24 | 21 | 1.25 | 8 | 1.25 | 42 | 6.0 |
| SLT-100-WM-AB | 3558 | Base Middle Top | 21.50 17.00 12.00 | 16.18 11.27 8.25 | .1875 | 38.01 40.96 26.79 | 1501 1209 556 | Round | 30 | 26 | 1.25 | 6 | 1.75 | 54 | 6.0 |
| SLT-100-WH-AB | 4722 | Base Middle Top | 22.00 17.00 13.00 | 16.06 12.15 8.98 | .2500 .2500 .2391 | 42.43 34.67 28.73 | 2226 1387 816 | Round | 30 | 26 | 1.25 | 12 | 1.5 | 54 | 6.0 |
| SLT-110-WL-AB | 3701 | Base Middle Top | 21.50 17.00 12.00 | 16.18 11.27 6.85 | .1875 | 38.01 40.96 36.79 | 1501 1209 710 | Round | 29 | 26 | 1.25 | 8 | 1.5 | 54 | 6.0 |
| SLT-110-WM-AB | 4942 | Base Middle Top | 22.00 17.00 13.00 | 16.06 12.15 7.58 | .2500 .2500 .2391 | 42.43 34.67 38.73 | 2226 1387 1028 | Round | 30 | 26.5 | 1.25 | 8 | 1.75 | 54 | 6.0 |
| SLT-110-WH-AB | 7296 | Base Middle Top | 27.25 22.00 16.88 | 20.97 16.06 12.72 | .3125 .2500 .1875 | 44.87 42.43 29.68 | 3706 2226 918 | Round | 36 | 32 | 1.5 | 16 | 1.5 | 54 | 6.0 |
| SLT-120-WL-AB | 3860 | Base Middle Top | 21.50 17.00 12.00 | 16.18 11.27 5.45 | .1875 | 38.01 40.96 46.79 | 1501 1209 835 | Round | 29 | 26 | 1.5 | 8 | 1.5 | 54 | 6.0 |
| SLT-120-WM-AB | 5155 | Base Middle Top | 22.00 17.00 13.00 | 16.06 12.15 6.18 | .2500 .2500 .2391 | 42.43 34.67 48.73 | 2226 1387 1203 | Round | 30 | 26.5 | 1.5 | 8 | 1.75 | 54 | 6.0 |
| SLT-120-WH-AB | 7557 | Base Middle Top | 27.25 22.00 16.88 | 20.97 16.06 11.32 | .3125 .2500 .1875 | 44.87 42.43 39.68 | 3706 2226 1169 | Round | 30 | 32 | 1.5 | 16 | 1.5 | 54 | 6.0 |